

MISC. ORDER NO. 2019-42

IN THE COUNTY COURT OF CRAIGHEAD COUNTY, ARKANSAS

IN THE MATTER OF AWARDED BIDS  
FOR ASPHALT PAVING AND PATCHING  
OF COUNTY ROADS

**FILED**

**MAY 13 2019**

KADE HOLLIDAY  
COUNTY & PROBATE COURT CLERK

**ORDER**

COMES BEFORE THE COUNTY COURT THE MATTER OF AWARDED BIDS FOR THE  
PURCHASE AND LAYING OF ASPHALT CONCRETE HOT MIX SURFACE AND BINDER  
MATERIAL AND FOR REPAIR AND PATCHING ON VARIOUS SECTIONS OF COUNTY  
ROADS

AS ROADS ARE MADE READY BY THE CRAIGHEAD COUNTY ROAD DEPARTMENT.  
BIDS WERE ADVERTISED AND PUBLICLY OPENED IN ACCORDANCE WITH  
ARKANSAS CODE 14-22-101 THROUGH 14-22-115 CONCERNING PUBLIC BIDDING. IT IS  
THEREFORE CONSIDERED, ORDERED AND ADJUDGED THAT THE LOW OVERALL  
BID OF \$491,337.75 BE ACCEPTED FROM ASPHALT PRODUCERS, LLC, PO BOX  
1492, JONESBORO, AR 72403.

DATED THIS 13<sup>th</sup> DAY OF MAY 2019.

APPROVED:

  
MARVIN DAY  
CRAIGHEAD COUNTY JUDGE

AAI  
175

FROM:

Craighead County Purchasing Department  
c/o County Judges Office  
511 Union Rm 119  
Jonesboro, AR 72401  
Phone 870-933-4500  
Fax 870-933-4504

**PURCHASE ORDER**  
**CRAIGHEAD COUNTY**  
**ARKANSAS**

**SHOW THIS NO. ON ALL INVOICES,  
DELIVERY SLIPS, CASES, BOXES, ETC**

PURCHASE  
ORDER

**51973**

TO: *Asphalt Producers, LLC*  
*PO Box 1492*  
*Jonesboro, AR 72403*

DATE *5-13-19*

Req. By \_\_\_\_\_

Req. # \_\_\_\_\_

Bld No. *2019-22*

Charge to  
Account No.

Gentlemen: Please furnish the following to Craighead County and be governed by the instructions hereon.

ITEM	QUAN.	BRAND, CATALOG NO. AND DESCRIPTION	UNIT PRICE	TOTAL
		<i>Furnish &amp; Lay binder and Asphalt on CR 372</i>		<i>318,402.75</i>
		<i>Furnish Asphalt and repair deteriorated areas on CR 759</i>		<i>172,935.00</i>
		<i>All materials and application procedures must meet all County and State requirements in bid P59 2015-22</i>		
		<i>total</i>		<i>491,337.75</i>

**TOTAL**

SHIP TO:

*Craighead County Road Dist.*  
*2500 Moore Rd*  
*Jonesboro, AR 72401*

DEL. PROMISED

DEL. REQUIRED

TERMS:

F.O.B.

*Destination*

PRICING:

No purchases over \$100.00 are valid unless covered by this form signed by Purchasing Agent. Submit invoice promptly to County Clerk, Craighead County Court House, P.O. Box 1167, Jonesboro, AR 72401. The above Purchase Order No. must appear on all Invoices, Delivery Slips, Cases, Boxes, Etc. even when shipped direct by your supplier.

I certify that all the above articles or services have been received in good order except as noted.

Dated \_\_\_\_\_ 20\_\_\_\_

Signed \_\_\_\_\_

**CRAIGHEAD COUNTY**

By

*[Signature]*

Purchasing Agent

**Bid No. 2019-22**

Asphalt paving and patching of various county roads

DATE: May 13, 2019

Craighead County Road Department

2800 Moore Road

Jonesboro, AR 72401

Atlas Asphalt

PO Box 2500

Jonesboro, AR 72402

**Brian Fulkerson**

Ph 932-1246

Fax 335-6687

Asphalt Producers, LLC

PO Box 1492

Jonesboro, AR 72403

John Broadway

Ph 932-1306

Fax 932-1554

Sugg Construction, Inc

PO Box 17164
--------------

Jonesboro, AR 72403

**Job number of County Roads to be paved& patched.**

[illegible]

**CRAIGHEAD COUNTY**  
**INVITATION TO BID-Not an Order**

Craighead County Judge's Office  
511 Union St. Suite 119  
Jonesboro, Arkansas 72401

**PURCHASING OFFICE**

**BID NO. 2019-22**

**DATE April 23, 2019**

Sealed bids, subject to the conditions on the attached hereof, and as may be attached hereto, will be received at this office until 2:00 PM May 8, 2019 and then publicly opened, for furnishing the supplies, materials, and/or services as described below.

Bids will be opened May 8, 2019  
2:00 P.M.

FOB Craighead County, Arkansas

BY: Al Haines

Maximum Delivery or completion time after issuance of Purchase Order or work ordered by County 120 days

Item #	DESCRIPTION
1	The intent of the attached specifications is to describe asphalt paving, asphalt overlay, and type of materials to use for paving and overlaying County Roads in Craighead County.
2	The successful bidder will furnish Craighead County a signed copy of all delivery receipts for each road or job, and will invoice the County for each job individually.
3	Does bidder meet all specifications? Yes <input checked="" type="checkbox"/> No <input type="checkbox"/> If no, please attach sheets explaining differences.
4	Successful bidder shall maintain bid price throughout the 2019 paving season.
5	Bidder should specify approximate start date if awarded bid. Days <u>120</u>
6	Bidder shall quote per laid ton price on asphalt and per gallon of prime/tack per road or job.
7	Bid must be signed by an authorized representative or bid will be rejected.
8	Bidder should return all pages of this bid package.
9	Bid # 2019-22 must be noted on the outside of bidders envelope.
10	Bidder shall specify any cash discounts, if available.
11	Bidder should list total tons: <b>Total tons of Asphalt</b> <u>6,925</u>
12	Bidder should list price: <b>Total cost for all jobs \$</b> <u>491,337.75</u>

**EXECUTION OF BID**

Date 5/8/2019

We, the undersigned, have read all the requirements set forth in this bid proposal including specifications, conditions, and pertinent information regarding the articles being bid on, and we agree to furnish articles at the prices instructions, stated.

Arkansas use Tax Register No. 00326691-SLS

Bidder Asphalt Producers LLC Address 1721 Dan Avenue

By John Broadaway City Jonesboro, AR 72401

(Person Authorized to Sign Bids)

Title

John Broadaway

President

**UNSIGNED BIDS WILL BE REJECTED**

**BIDS ARE SUBJECT TO REJECTION UNLESS SUBMITTED ON THIS FORM**

**ICE TO BIDDERS, SEE REVERSE SIDE OR ATTACHMENTS FOR INSTRUCTIONS AND CONDITIONS.**

**CRAIGHEAD COUNTY  
JONESBORO, ARKANSAS**

**CONDITIONS OF BIDDING**

**Compliance with the following conditions is necessary for consideration of this bid.**

- 1 Signature-This bid must be signed with the firm name and by an authorized officer, employee or agent.
- 2 Sales Tax-Is not to be shown in the bid price, but is to be added by the vendor to the invoice billing to the County. The County is not exempt from Arkansas State Sales Tax. Contractors are to include all costs into the bid price, including applicable taxes.
- 3 Freight and other delivery charges-to destination at designated County job site in the County must be included in bid. Charges may not be added after the bid is opened.
- 4 Discounts-Show rate, total amount, and latest day any discounts will be allowed after receipt of article and invoice, otherwise County will deduct allowed discount when payment is made.
- 5 Firm Price-All prices quoted will remain firm for at least 30 days from date of bid, unless otherwise specified by the County or bidder
- 6 Identical Bids-In the event of two or more identical low bids, the contract may be awarded arbitrarily or for any reason to any of such bidders, or split in any proportion between the said two or more bidders at discretion of the County.
- 7 Clean up-Complete cleanup and proper disposal of any and all job related items is considered to be a part of any contract let by Craighead County.
- 8 Ambiguity in bid-Any ambiguity in any bid as the result of omission, error, lack of clarity or non-compliance specifications, instructions, and all conditions of bidding shall be construed in the light most favorable to the County
- 9 Construction  
A. When requested, the Contractor is to supply the County with evidence of having and maintaining proper and specifically Workman's Compensation Insurance in accordance with the laws of the State of Arkansas, Public Liability, and Property Damage. All premiums and cost shall be paid by Contractor. In no way will the County be responsible in case of accident.  
B. A Performance Bond equaling the total amount of any bid exceeding \$20,000 must be provided for erection of any public building, public structure, or public improvement(Pursuant to Arkansas Code 18-44-503.)
- 10 The County reserves the right to reject any and all bids, accept in whole or in part, to waive informalities in bids received, to accept bids on materials or equipment with variations from specifications in those cases where efficiency of operation will not be impaired, and unless otherwise specified by bidder, to accept any item in the bid. If unit prices and extensions thereof do not coincide, the County may accept the bid for the lesser amount whether reflected by extension or by the correct multiple of the unit price.

**INSTRUCTIONS TO BIDDERS**

(Please read carefully)

- 1 Submit bid on bid form attached.
- 2 Address all bids to: Purchasing Director, Craighead County Judge's Office, 511 Union St.; Suite 119, Jonesboro, Arkansas 72401 and make certain to indicate identifying bid number on the outside of bid envelope.
- 3 DO NOT include Federal Excise Tax in bid. County will furnish exemption certificate.
- 4 Bids received after stated time will not be considered.
- 5 Be sure and read all conditions and verify amounts before submitting bids. No changes or additions will be allowed after submission.
- 6 Guarantees and warranties should be attached as a part of the bid, as they may be a consideration in awarding contract.
- 7 Delivery or contract completion time is to be shown, as this date may, where time is of the essence, determine the contract award.
- 8 Additional information may be obtained from the Purchasing Department.

**THE COUNTY RESERVES THE RIGHT TO ACCEPT PART OR ALL OF ANY SPECIFIC BID OR BIDS  
AND TO ACCEPT BID WITH OR WITHOUT TRADE-IN, AND REJECT ANY AND ALL BIDS.**

# SPECIFICATIONS

Scope: To furnish and lay asphalt concrete hot mix surface course material to Craighead County, Arkansas. All Materials under this bid will conform to the standard specifications of the AHTD (Arkansas Highway Transportation Department) edition 2014, Special Provisions, or latest edition.

Type: ACHM surface 12.5 laid on County Roads.

Each job listed below must be bid separately and, each job order will be issued as roads are made ready for the asphalt overlay.

These figures are approximate. Please look at the job, calculate tonnage and gallons and give bid on work at cost per ton on asphalt and per gallon on tack.

Craighead County stipulates that the successful bidder will do other priming and paving or asphalt overlay jobs at the bid price, should other monies become available to Craighead County.

Craighead County reserves the right to accept, reject, in whole or in part, to waive informalities in bids received, or accept bids with variations.

Traffic control shall be responsibility of contractor.

**Note: Job A, CR 759, Contractor will remove unstable material and repair according to Section 415, Asphalt Concrete Hot Mix Patching of Existing Roadway.**

## Job number of County Roads to be overlayed (Patching)

			Estimated Asphalt Tons	Estimated Tack(Gallons)	Price Per Ton	Price Per Gallon	Total Price
Job	CR 759	Patching 4" (25.0mm)	1,700		\$80.76		\$137,292.00
A		Overlay 2" (12.5mm)	2,600	2,325(0.10 gal sy)	\$67.02	\$2.95	\$181,110.75
		Patching Prep					
						All Total	\$318,402.75

## Job number of County Roads to be paved:

			Estimated Asphalt Tons	Estimated Tack(Gallons)	Price Per Ton	Price Per Gallon	Total Price
Job	CR 372	Binder 3" (25.0mm)	1,750		\$63.54		\$111,195.00
B		Surface 1 1/2 " (12.5mm)	875	1,050(0.10 gal sy)	\$67.02	\$2.95	\$61,740.00
						All Total	\$172,935.00

Job A + Job B All Total: \$491,337.75

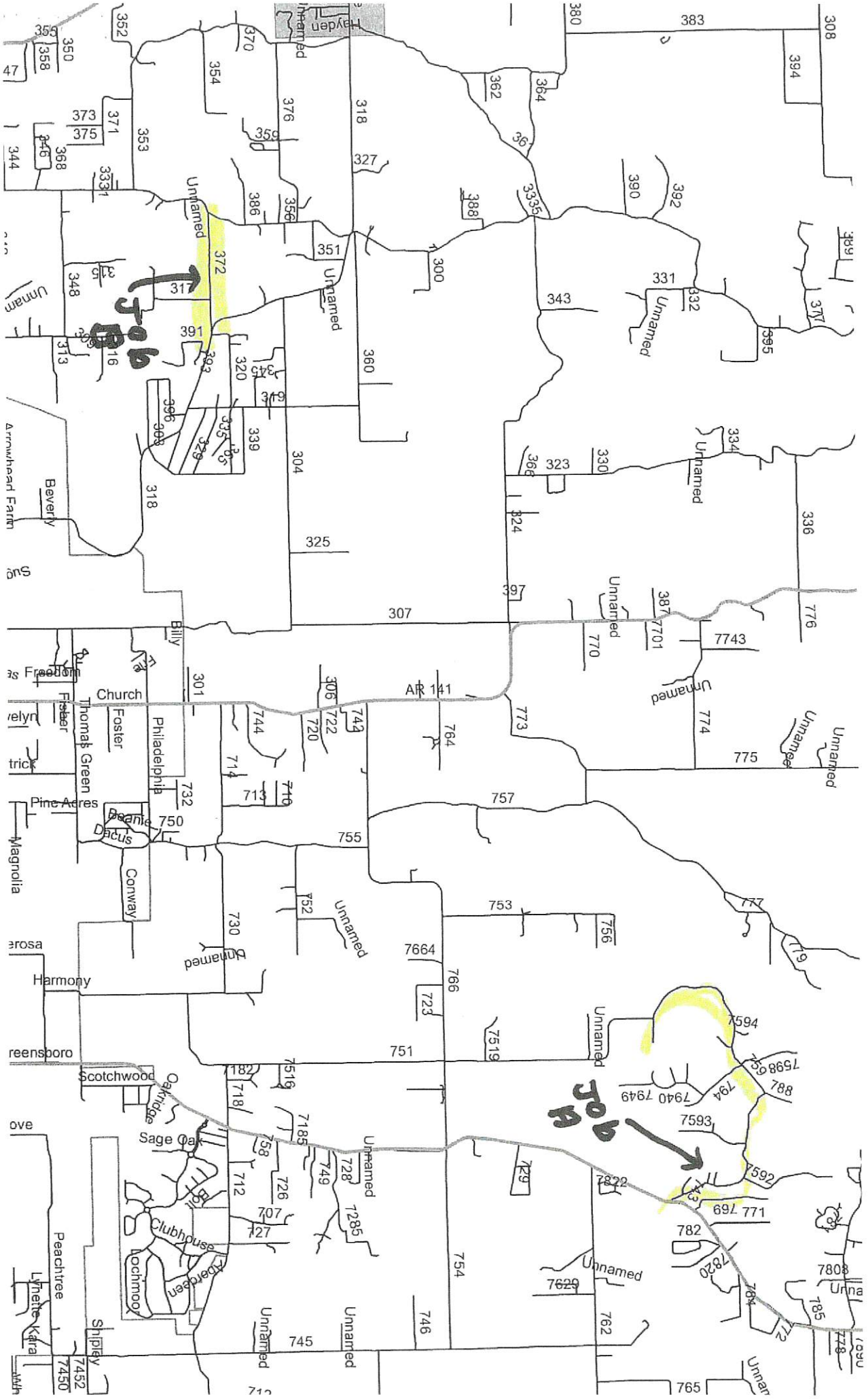

ADDENDUM 1

Bid 2019-22 Asphalt paving and patching.

Addendum 1 Craighead reserves the right to have any milling of product removed from asphalt patching on CR 759 to be loaded onto county truck at the discretion of Craighead County.

Bidder shall respond that addendum was received and becomes part of the bid package.

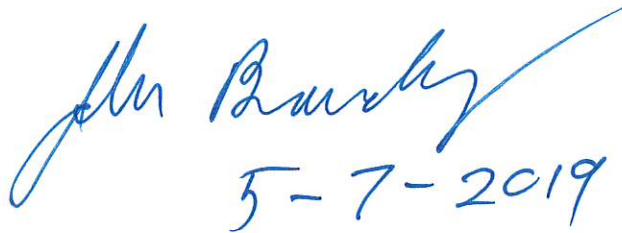
A handwritten signature in blue ink, appearing to read "John Barkley", with a long horizontal stroke extending to the right. Below the signature is the date "5-7-2019" written in the same blue ink.

5-7-2019

**CRAIGHEAD COUNTY  
INVITATION TO BID-Not an Order**

Craighead County Judge's Office  
511 Union St. Suite 119  
Jonesboro, Arkansas 72401

**PURCHASING OFFICE**

**BID NO. 2019-22**

**DATE April 23, 2019**

Sealed bids, subject to the conditions on the attached hereof, and as may be attached hereto, will be received at this office until **2:00 PM May 8, 2019** and then publicly opened, for furnishing the supplies, materials, and/or services as described below.

Bids will be opened **May 8, 2019,  
2:00 P.M.**

**FOB Craighead County, Arkansas**

**BY: Al Haines**

Maximum Delivery or completion time after issuance of Purchase Order or work ordered by County **120 days.**

- | Item # | DESCRIPTION  |
|--------|--|
| 1      | The intent of the attached specifications is to describe asphalt paving, asphalt overlay, and type of materials to use for paving and overlaying County Roads in Craighead County. |
| 2      | The successful bidder will furnish Craighead County a signed copy of all delivery receipts for each road or job, and will invoice the County for each job individually.            |
| 3      | Does bidder meet all specifications? Yes <input checked="" type="checkbox"/> No <input type="checkbox"/><br>If no, please attach sheets explaining differences.                    |
| 4      | Successful bidder shall maintain bid price throughout the 2019 paving season.  |
| 5      | Bidder should specify approximate start date if awarded bid. Days <b>12</b>  |
| 6      | Bidder shall quote per laid ton price on asphalt and per gallon of prime/tack per road or job.   |
| 7      | Bid must be signed by an authorized representative or bid will be rejected.  |
| 8      | Bidder should return all pages of this bid package.  |
| 9      | Bid # 2019-22 must be noted on the outside of bidders envelope.  |
| 10     | Bidder shall specify any cash discounts, if available.   |
| 11     | Bidder should list total tons: <b>Total tons of Asphalt 6,975 tons</b>   |
| 12     | Bidder should list price: <b>Total cost for all jobs \$ 508,056</b>  |

**EXECUTION OF BID**

Date **May 8 2019**

We, the undersigned, have read all the requirements set forth in this bid proposal including specifications, conditions, and pertinent information regarding the articles being bid on, and we agree to furnish articles at the prices instructions, stated.

Arkansas use Tax Register No. **73714304 - 565**

Bidder **Sugg Construction Inc.** Address **P.O. Box 17164**  
By **[Signature]** City **Jonesboro, AR 72403**  
(Person Authorized to Sign Bids) Title **Vice President**

**UNSIGNED BIDS WILL BE REJECTED**

**BIDS ARE SUBJECT TO REJECTION UNLESS SUBMITTED ON THIS FORM**

**ICE TO BIDDERS, SEE REVERSE SIDE OR ATTACHMENTS FOR INSTRUCTIONS AND CONDITIONS.**

**CRAIGHEAD COUNTY  
JONESBORO, ARKANSAS**

**CONDITIONS OF BIDDING**

**Compliance with the following conditions is necessary for consideration of this bid.**

- 1 Signature-This bid must be signed with the firm name and by an authorized officer, employee or agent.
- 2 Sales Tax-Is not to be shown in the bid price, but is to be added by the vendor to the invoice billing to the County. The County is not exempt from Arkansas State Sales Tax. Contractors are to include all costs into the bid price, including applicable taxes.
- 3 Freight and other delivery charges-to destination at designated County job site in the County must be included in bid. Charges may not be added after the bid is opened.
- 4 Discounts-Show rate, total amount, and latest day any discounts will be allowed after receipt of article and invoice, otherwise County will deduct allowed discount when payment is made.
- 5 Firm Price-All prices quoted will remain firm for at least 30 days from date of bid, unless otherwise specified by the County or bidder
- 6 Identical Bids-In the event of two or more identical low bids, the contract may be awarded arbitrarily or for any reason to any of such bidders, or split in any proportion between the said two or more bidders at discretion of the County.
- 7 Clean up-Complete cleanup and proper disposal of any and all job related items is considered to be a part of any contract let by Craighead County.
- 8 Ambiguity in bid-Any ambiguity in any bid as the result of omission, error, lack of clarity or non-compliance specifications, instructions, and all conditions of bidding shall be construed in the light most favorable to the County
- 9 Construction
  - A. When requested, the Contractor is to supply the County with evidence of having and maintaining proper and specifically Workman's Compensation Insurance in accordance with the laws of the State of Arkansas, Public Liability, and Property Damage. All premiums and cost shall be paid by Contractor. In no way will the County be responsible in case of accident.
  - B. A Performance Bond equaling the total amount of any bid exceeding \$20,000 must be provided for erection of any public building, public structure, or public improvement(Pursuant to Arkansas Code 18-44-503.)
- 10 The County reserves the right to reject any and all bids, accept in whole or in part, to waive informalities in bids received, to accept bids on materials or equipment with variations from specifications in those cases where efficiency of operation will not be impaired, and unless otherwise specified by bidder, to accept any item in the bid. If unit prices and extensions thereof do not coincide, the County may accept the bid for the lesser amount whether reflected by extension or by the correct multiple of the unit price.

**INSTRUCTIONS TO BIDDERS**

(Please read carefully)

- 1 Submit bid on bid form attached.
- 2 Address all bids to: Purchasing Director, Craighead County Judge's Office, 511 Union St., Suite 119, Jonesboro, Arkansas 72401 and make certain to indicate identifying bid number on the outside of bid envelope.
- 3 DO NOT include Federal Excise Tax in bid. County will furnish exemption certificate.
- 4 Bids received after stated time will not be considered.
- 5 Be sure and read all conditions and verify amounts before submitting bids. No changes or additions will be allowed after submission.
- 6 Guarantees and warranties should be attached as a part of the bid, as they may be a consideration in awarding contract.
- 7 Delivery or contract completion time is to be shown, as this date may, where time is of the essence, determine the contract award.
- 8 Additional information may be obtained from the Purchasing Department.

**THE COUNTY RESERVES THE RIGHT TO ACCEPT PART OR ALL OF ANY SPECIFIC BID OR BIDS  
AND TO ACCEPT BID WITH OR WITHOUT TRADE-IN, AND REJECT ANY AND ALL BIDS.**

SPECIFICATIONS							
1	Scope: To furnish and lay asphalt concrete hot mix surface course material to Craighead County, Arkansas. All Materials under this bid will conform to the standard specifications of the AHTD (Arkansas Highway Transportation Department) edition 2014, Special Provisions, or latest edition.						
2	Type: ACHM surface 12.5 laid on County Roads.						
3	Each job listed below must be bid separately and, each job order will be issued as roads are made ready for the asphalt overlay.						
4	These figures are approximate. Please look at the job, calculate tonnage and gallons and give bid on work at cost per ton on asphalt and per gallon on tack.						
5	Craighead County stipulates that the successful bidder will do other priming and paving or asphalt overlay jobs at the bid price, should other monies become available to Craighead County.						
6	Craighead County reserves the right to accept, reject, in whole or in part, to waive informalities in bids received, or accept bids with variations.						
7	Traffic control shall be responsibility of contractor.						
8	<b>Note: Job A, CR 759, Contractor will remove unstable material and repair according to Section 415, Asphalt Concrete Hot Mix Patching of Existing Roadway.</b>						
<b>Job number of County Roads to be overlayed (Patching)</b>							
			Estimated Asphalt Tons	Estimated Tack(Gallons)	Price Per Ton	Price Per Gallon	Total Price
Job	CR 759	Patching 4" (25.0mm)	1,700		113.25		192,525
A		Overlay 2" (12.5mm)	2,600	2,325(0.10 gal sy)	79.37	3	213,343
		Patching Prep					5,000
						All Total	410,868 <sup>00</sup>
<b>Job number of County Roads to be paved:</b>							
			Estimated Asphalt Tons	Estimated Tack(Gallons)	Price Per Ton	Price Per Gallon	Total Price
Job	CR 372	Binder 3" (25.0mm)	1,750		71.75		25,547
		Surface 1 1/2 " (12.5mm)	875	1,050(0.10 gal sy)	78.30	3	71,666
						All Total	97,213 <sup>00</sup>

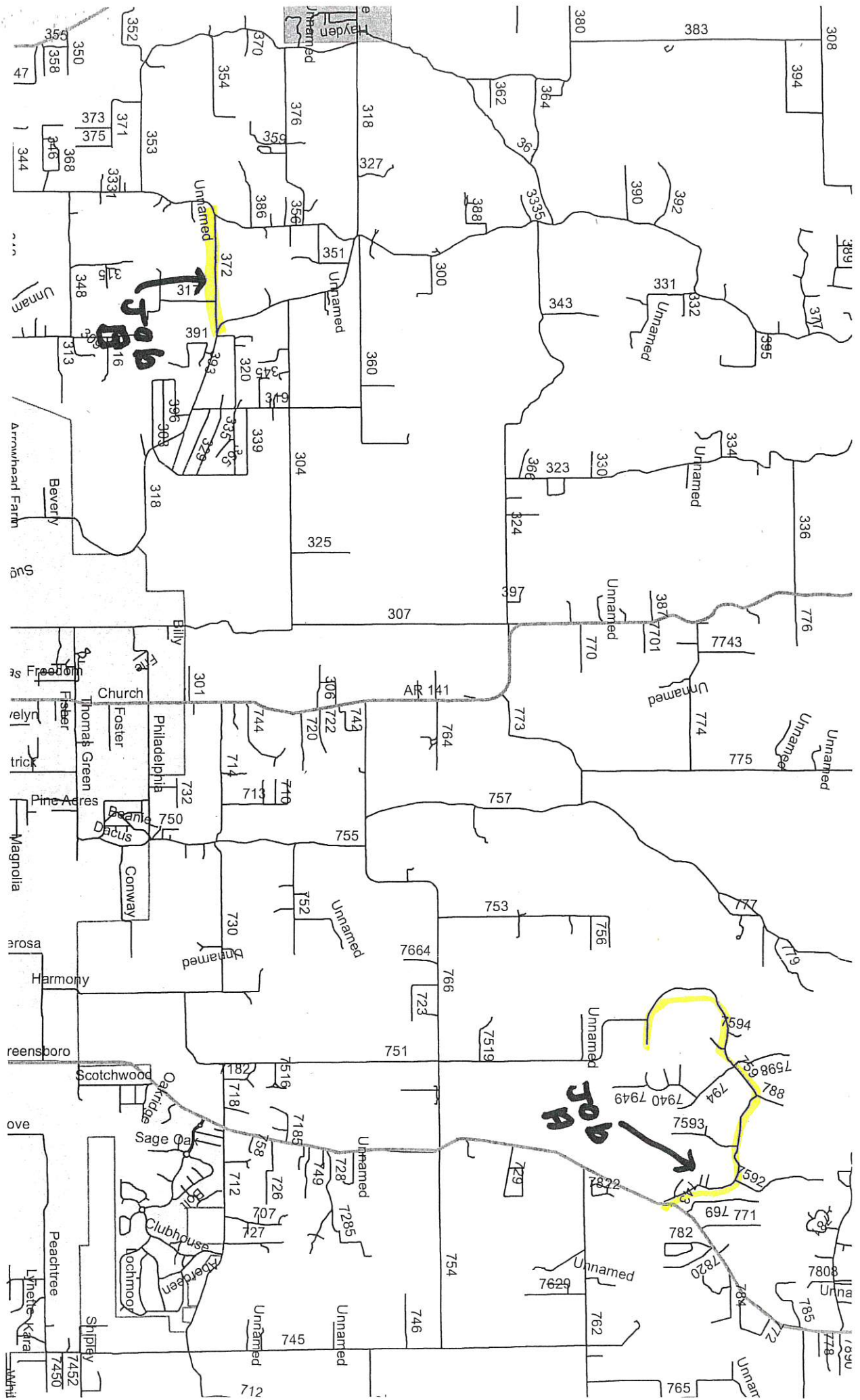

**CRAIGHEAD COUNTY**  
**INVITATION TO BID-Not an Order**

Craighead County Judge's Office  
511 Union St. Suite 119  
Jonesboro, Arkansas 72401

**PURCHASING OFFICE**

**BID NO. 2019-22**

**DATE April 23, 2019**

Sealed bids, subject to the conditions on the attached hereof, and as may be attached hereto, will be received at this office until 2:00 PM May 8, 2019 and then publicly opened, for furnishing the supplies, materials, and/or services as described below.

Bids will be opened May 8, 2019.

2:00 P.M.

**FOR Craighead County, Arkansas**

**BY: Al Haines**

Maximum Delivery or completion time after issuance Purchasing Director

of Purchase Order or work ordered by County 120 days.

Item #	DESCRIPTION
1	The intent of the attached specifications is to describe asphalt paving, asphalt overlay, and type of materials to use for paving and overlaying County Roads in Craighead County.
2	The successful bidder will furnish Craighead County a signed copy of all delivery receipts for each road or job, and will invoice the County for each job individually.
3	Does bidder meet all specifications? Yes <u>X</u> No <u>    </u> If no, please attach sheets explaining differences.
4	Successful bidder shall maintain bid price throughout the 2019 paving season.
5	Bidder should specify approximate start date if awarded bid. Days <u>July 1, 2019</u>
6	Bidder shall quote per laid ton price on asphalt and per gallon of prime/tack per road or job.
7	Bid must be signed by an authorized representative or bid will be rejected.
8	Bidder should return all pages of this bid package.
9	Bid # 2019-22 must be noted on the outside of bidders envelope.
10	Bidder shall specify any cash discounts, if available.
11	Bidder should list total tons: <b>Total tons of Asphalt</b> <u>6,925.00</u>
12	Bidder should list price: <b>Total cost for all jobs</b> <u>\$ 533,662.00</u>

**EXECUTION OF BID**

Date May 8, 2019

We, the undersigned, have read all the requirements set forth in this bid proposal including specifications, conditions, and pertinent information regarding the articles being bid on, and we agree to furnish articles at the prices instructions, stated.

Arkansas use Tax Register No. 71-0480598

Bidder Atlas Asphalt, Inc.

Address P.O. Box 2500

By Brian Fulkerson City Jonesboro, AR 72402

Brian Fulkerson (Person Authorized to Sign Bids) Title Vice-President

**UNSIGNED BIDS WILL BE REJECTED**

**BIDS ARE SUBJECT TO REJECTION UNLESS SUBMITTED ON THIS FORM**

**SEE REVERSE SIDE OR ATTACHMENTS FOR INSTRUCTIONS AND CONDITIONS.**

**CRAIGHEAD COUNTY  
JONESBORO, ARKANSAS**

**CONDITIONS OF BIDDING**

**Compliance with the following conditions is necessary for consideration of this bid.**

- 1 **Signature**-This bid must be signed with the firm name and by an authorized officer, employee or agent.
- 2 **Sales Tax**-Is not to be shown in the bid price, but is to be added by the vendor to the invoice billing to the County. The County is not exempt from Arkansas State Sales Tax. Contractors are to include all costs into the bid price, including applicable taxes.
- 3 **Freight and other delivery charges**-to destination at designated County job site in the County must be included in bid. Charges may not be added after the bid is opened.
- 4 **Discounts**-Show rate, total amount, and latest day any discounts will be allowed after receipt of article and invoice, otherwise County will deduct allowed discount when payment is made.
- 5 **Firm Price**-All prices quoted will remain firm for at least 30 days from date of bid, unless otherwise specified by the County or bidder
- 6 **Identical Bids**-In the event of two or more identical low bids, the contract may be awarded arbitrarily or for any reason to any of such bidders, or split in any proportion between the said two or more bidders at discretion of the County.
- 7 **Clean up**-Complete cleanup and proper disposal of any and all job related items is considered to be a part of any contract let by Craighead County.
- 8 **Ambiguity in bid**-Any ambiguity in any bid as the result of omission, error, lack of clarity or non-compliance specifications, instructions, and all conditions of bidding shall be construed in the light most favorable to the County
- 9 **Construction**  
A. When requested, the Contractor is to supply the County with evidence of having and maintaining proper and specifically Workman's Compensation Insurance in accordance with the laws of the State of Arkansas, Public Liability, and Property Damage. All premiums and cost shall be paid by Contractor. In no way will the County be responsible in case of accident.  
B. A Performance Bond equaling the total amount of any bid exceeding \$20,000 must be provided for erection of any public building, public structure, or public improvement(Pursuant to Arkansas Code 18-44-503.)
- 10 The County reserves the right to reject any and all bids, accept in whole or in part, to waive informalities in bids received, to accept bids on materials or equipment with variations from specifications in those cases where efficiency of operation will not be impaired, and unless otherwise specified by bidder, to accept any item in the bid. If unit prices and extensions thereof do not coincide, the County may accept the bid for the lesser amount whether reflected by extension or by the correct multiple of the unit price.

**INSTRUCTIONS TO BIDDERS**

(Please read carefully)

- 1 Submit bid on bid form attached.
- 2 Address all bids to: Purchasing Director, Craighead County Judge's Office, 511 Union St.; Suite 119, Jonesboro, Arkansas 72401 and make certain to indicate identifying bid number on the outside of bid envelope.
- 3 DO NOT include Federal Excise Tax in bid. County will furnish exemption certificate.
- 4 Bids received after stated time will not be considered.
- 5 Be sure and read all conditions and verify amounts before submitting bids. No changes or additions will be allowed after submission.
- 6 Guarantees and warranties should be attached as a part of the bid, as they may be a consideration in awarding contract.
- 7 Delivery or contract completion time is to be shown, as this date may, where time is of the essence, determine the contract award.
- 8 Additional information may be obtained from the Purchasing Department.

**THE COUNTY RESERVES THE RIGHT TO ACCEPT PART OR ALL OF ANY SPECIFIC BID OR BIDS  
AND TO ACCEPT BID WITH OR WITHOUT TRADE-IN, AND REJECT ANY AND ALL BIDS.**

			<b>SPECIFICATIONS</b>				
1		Scope: To furnish and lay asphalt concrete hot mix surface course material to Craighead County, Arkansas. All Materials under this bid will conform to the standard specifications of the AHTD (Arkansas Highway Transportation Department) edition 2014, Special Provisions, or latest edition.					
2		Type: ACHM surface 12.5 laid on County Roads.					
3		Each job listed below must be bid separately and, each job order will be issued as roads are made ready for the asphalt overlay.					
4		These figures are approximate. Please look at the job, calculate tonnage and gallons and give bid on work at cost per ton on asphalt and per gallon on tack.					
5		Craighead County stipulates that the successful bidder will do other priming and paving or asphalt overlay jobs at the bid price, should other monies become available to Craighead County.					
6		Craighead County reserves the right to accept, reject, in whole or in part, to waive informalities in bids received, or accept bids with variations.					
7		Traffic control shall be responsibility of contractor.					
8		<b>Note: Job A, CR 759, Contractor will remove unstable material and repair according to Section 415, Asphalt Concrete Hot Mix Patching of Existing Roadway.</b>					
		<b>Job number of County Roads to be overlaid (Patching)</b>					
			Estimated Asphalt Tons	Estimated Tack(Gallons)	Price Per Ton	Price Per Gallon	Total Price
Job	CR 759	Patching 4" (25.0mm)	1,700		\$85.00		\$144,500.00
A		Overlay 2" (12.5mm)	2,600	2,325(0.10 gal sy)	\$71.72	\$3.00	\$193,447.00
		Patching Prep			\$12,000.00		\$12,000.00
						All Total	\$349,947.00
		<b>Job number of County Roads to be paved:</b>					
			Estimated Asphalt Tons	Estimated Tack(Gallons)	Price Per Ton	Price Per Gallon	Total Price
Job	B	C Binder 3" (25.0mm)	1,750		\$67.32		\$117,810.00
	CR 372	Surface 1 1/2 " (12.5mm)	875	1,050(0.10 gal sy)	\$71.72	\$3.00	\$65,905.00
						All Total	\$183,715.00

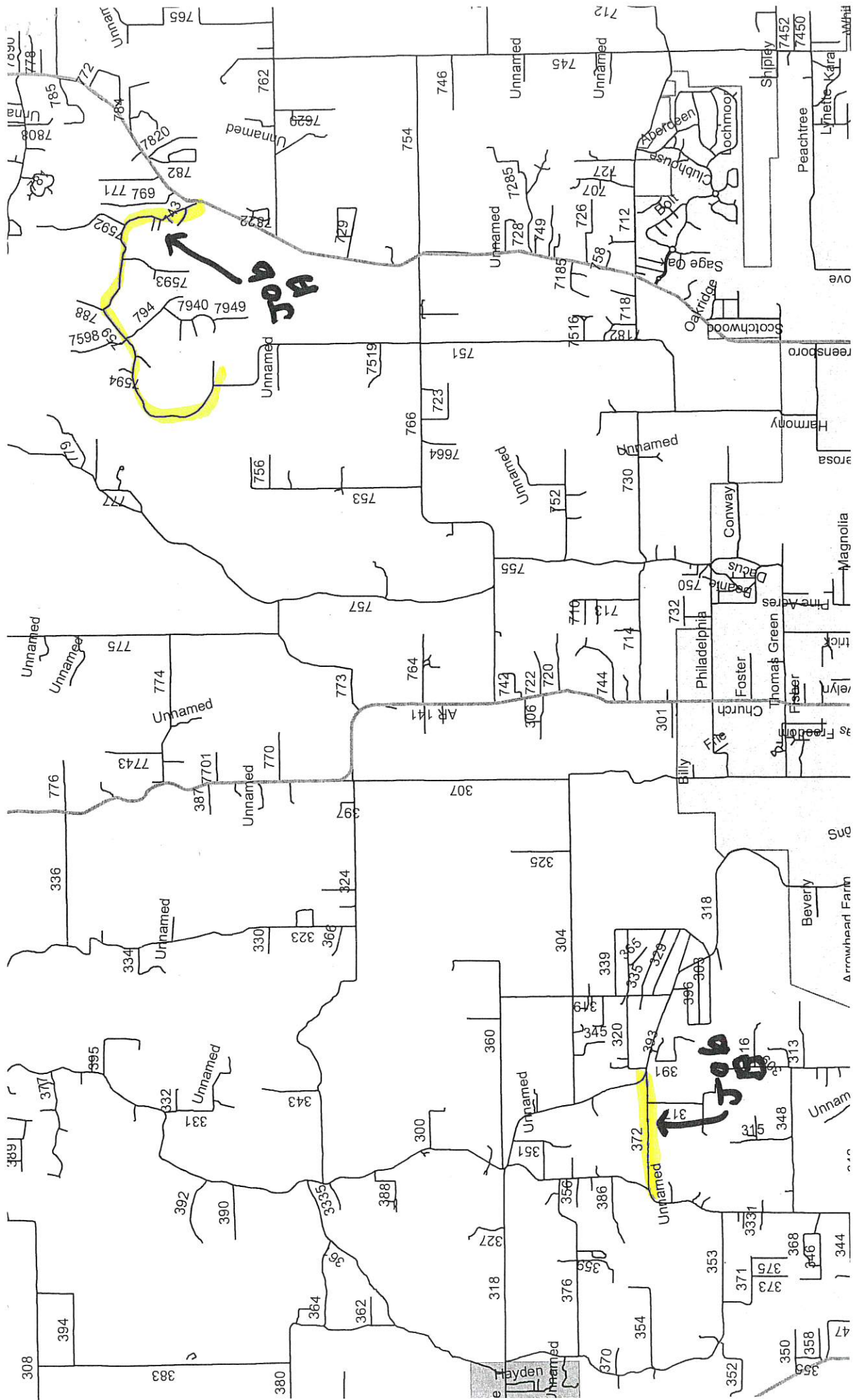

## ADDENDUM 1

Bid 2019-22 Asphalt paving and patching.

Addendum 1     Craighead reserves the right to have any milling of product removed from asphalt patching on CR 759 to be loaded onto county truck at the discretion of Craighead County.

Bidder shall respond that addendum was received and becomes part of the bid package.

Mary Ann ACCOUNTS PAYABLE  
Craighead County Legals  
PO BOX 1167  
JONESBORO, AR 72403  
(870)933-4520

*Class Liner Ad #90791099 Summary:*

Description: Asphalt Paving & Patching  
Size: 1.00 x 4.99

Net Cost           \$78.65  
Prepaid Amount   \$0.00  
Amount Due       \$78.65

If paid by credit card, your statement will show the charge as "Newspaper Services - Paxton Media"

*Order Detail:*

Publication	Start	Stop	Insertions
20JN Jonesboro Sun	4/25/19	4/25/19	1

# The Jonesboro Sun

DAILY AND SUNDAY

## Proof of Publication

STATE OF ARKANSAS  
COUNTY OF CRAIGHEAD

I, Lisa A. Lynn solemnly swear that I  
am classified director of the JONESBORO SUN daily newspaper of general  
circulation printed in the Western District of Craighead County and I was such classified  
advertising manager at the date of publication hereinafter stated, and that said newspaper had  
a bonafide circulation in such county at said dates, and had been regularly published in said county  
for the period of one month next before the date of the first publication of the advertisement hereto  
affixed, and that said advertisement was published in said

newspaper 1 times once a week for 1

weeks consecutively, the first insertion therein having been made on the

25 day of April, 2019

2nd insertion \_\_\_\_\_ day of \_\_\_\_\_

3rd insertion \_\_\_\_\_ day of \_\_\_\_\_

4th insertion \_\_\_\_\_ day of \_\_\_\_\_

5th insertion \_\_\_\_\_ day of \_\_\_\_\_

6th insertion \_\_\_\_\_ day of \_\_\_\_\_

7th insertion \_\_\_\_\_ day of \_\_\_\_\_

Sworn to and subscribed before me this 25 day of April, 2019

My commission expires 9-6-22

Fee for print. \$ 78.65

Cost of Proof \$ \_\_\_\_\_

Rec'd Payment \$ \_\_\_\_\_

Total --- \$ 78.65



## NOTICE TO BIDDERS

Craighead County is now accepting bids until 2:00 PM, May 8, 2019, local time, at the Craighead County Judge's office for the following:

Asphalt paying and patching overlay of various roads in Craighead County, Arkansas.

Bid specifications may be picked up at the County Judge's office, Craighead County Courthouse Annex, 511 Union St, Suite 119, Jonesboro, Arkansas, Monday through Friday, from 8:00 A.M. until 5:00 P.M.

Bids will be opened at 2:00 PM, May 8, 2019, local time, in the County Judge's office.

The County reserves the right to reject any or all bids or any part of any specific bid.

Bid specifications are available on the County Web Site at [www.craigheadcounty.org](http://www.craigheadcounty.org)

Al Haines  
Purchasing Agent  
Craighead County

## NOTICE TO BIDDERS

Craighead County is now accepting bids until 2:00 PM, May 8, 2019, local time, at the Craighead County Judge's office for the following:

Asphalt paying and patching overlay of various roads in Craighead County, Arkansas.

Bid specifications may be picked up at the County Judge's office, Craighead County Courthouse Annex, 511 Union St, Suite 119, Jonesboro, Arkansas, Monday through Friday, from 8:00 A.M. until 5:00 P.M.

Bids will be opened at 2:00 PM, May 8, 2019, local time, in the County Judge's office.

The County reserves the right to reject any or all bids or any part of any specific bid.

Bid specifications are available on the County Web Site at [www.craigheadcounty.org](http://www.craigheadcounty.org)

Al Haines  
Purchasing Agent  
Craighead County

3-00000592

**ADVERTISING INVOICE / STATEMENT**

1/1

BILLING DATE	TERMS OF PAYMENT
05/06/2019	Upon Receipt



\*\*\*\*\*AUTO\*\*ALL FOR AADC 380  
CRAIGHEAD COUNTY JUDGES OFFICE BILLING  
Dept  
511 Union St Ste 119  
Jonesboro AR 72401-2863

BILLED ACCOUNT NO.		AGENCY/CLIENT	
90035632		90035632	
NAME OF AGENCY/CLIENT			
CRAIGHEAD COUNTY JUDGES OFFICE BILLING			

DATE	AD #	TRANS #	DESCRIPTION	INS	UNITS	AMOUNT	TOTAL
			Balance Forward			124.80	124.80

PERIOD 4 2019	AGING			
	Period 3 2019	Period 2 2019	Period 1 2019	Period 12 2018
\$ 0.00	\$ 124.80	\$ 0.00	\$ 0.00	\$ 0.00

TOTAL NET AMOUNT DUE

**\$ 124.80**

PLEASE RETURN THIS PORTION  
WITH YOUR REMITTANCE

If you desire to charge this amount to your credit card, please complete the following information and return to the address below: ☐ Visa ☐ Mastercard ☐ Discover ☐ American Express

Acct# \_\_\_\_\_ Exp Date: \_\_\_\_\_

Signature \_\_\_\_\_

BILLED ACCOUNT NO		BILLED ACCOUNT NAME	AMOUNT DUE
124	90035632	CRAIGHEAD COUNTY JUDGES OFFICE	\$ 124.80

BM  
EOC  
BOC  
SAF

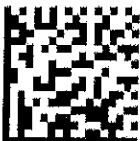

REMIT TO

Jonesboro Sun  
c/o Paxton Media Group  
PO Box 1200  
Paducah KY 42002

Phone: 270-575-8731  
Fax: 270-575-8726

Payment in full is due upon receipt of the statement. A service charge on all balances over 30 days will be computed by a 'Periodic Rate' of 1-1/2% per month, which is an ANNUAL PERCENTAGE RATE of 18%, this applies to the previous balance after deducting current payments and credits appearing on your statement. Refunds less than \$10.00 will be refunded electronically, donated to NIE, or collected in cash at the newspaper.

Remittance Advice

900356320000000000012480

Billing Date  
05/06/2019